



# 3 1/2" 203D FILLABLE U-CLAMP PANEL MOUNT

Dry yet fillable gauge for durability in applications where vibration or pulsation is present  
Stainless steel case and bezel, copper alloy internals

## SPECIFICATIONS

|   |                     |  |
|---|---------------------|--|
| 2 | <b>Dial</b>         | 3 1/2" (88 mm)   |
|   | <b>Case</b>         | Stainless steel, dry yet fillable                            |
|   | <b>Wetted Parts</b> | Copper alloy   |
|   | <b>Bezel</b>        | Stainless steel, fixed                                       |
|   | <b>Lens</b>         | Polycarbonate  |
|   | <b>Pointer</b>      | Black aluminum   |
|   | <b>Connection</b>   | Lower back mount with u-clamp<br>3 1/2" dial = 1/4" NPT      |
|   | <b>Scale</b>        | Standard: psi/BAR (x 100 = kPa)                              |
|   | <b>Accuracy</b>     | 2-1-2% of span, ASME B40.1 Grade A                           |
|   | <b>Ambient Temp</b> | Dry = -30° F to 180° F<br>Glycerine Filled = 30° F to 160° F |



*Design meets or exceeds ASME B40.100 pressure gauge standard.*

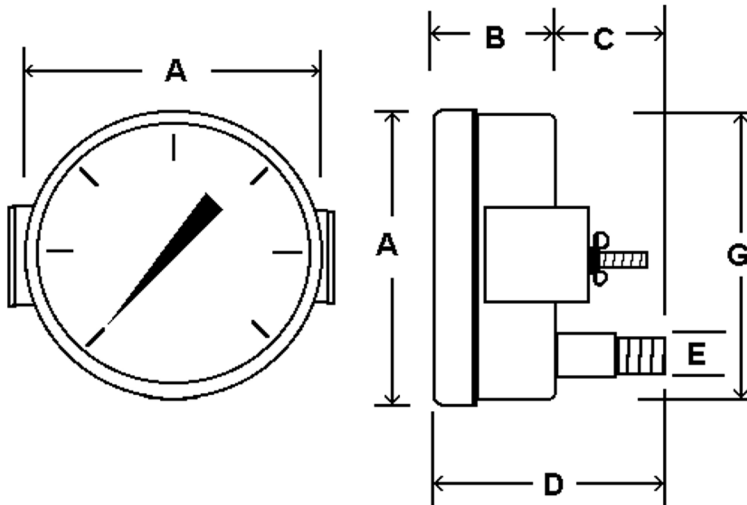

## AVAILABLE OPTIONS\*

- Certificate of Accuracy, NIST traceable
- Custom Dial
- Liquid Fill Options, see page 176
- Anti-Vibration Movement, see page 109
- Glass Lens
- Cleaned for Oxygen Service (dry only)
- Special Connection Size
- Max/Min Pointer, see page 122

\*Lead times/minimums may apply

## APPROXIMATE SHIPPING WEIGHTS/ BOX QUANTITIES

| Dial   | Unit | A     | B     | C     | D     | E        | G     |
|--------|------|-------|-------|-------|-------|----------|-------|
| 3 1/2" | In.  | 3.83" | 1.13" | 1.00" | 2.15" | 1/4" NPT | 3.50" |
|        | mm   | 97    | 29    | 25    | 55    |          | 89    |

| Dial Size | Est. Unit Weight      | Box Qty |
|-----------|-----------------------|---------|
| 3 1/2"    | 0.60 lbs<br>(0.28 kg) | 50      |