

6001 6" ALL STAINLESS LOWER MOUNT



Heavy duty, all stainless steel gauge with removable bezel, adjustable pointer
1% accuracy, welded case-to-stem connection, dry yet fillable

SPECIFICATIONS

| | |
|---------------------|---|
| Dial | 6" (150 mm) |
| Case | Stainless steel, dry yet fillable Welded case-to-stem connection |
| Wetted Parts | 316 stainless steel |
| Movement | With overload/underload stops |
| Bezel | Removable, stainless steel |
| Lens | Laminated safety glass |
| Pointer | Micro adjustable, black aluminum |
| Connection | Lower mount 1/4" or 1/2" NPT |
| Scale | Standard: single scale psi |
| Accuracy | 1% of span ASME B40.1 Grade 1A |
| Ambient Temp | Dry = -30° F to 180° F Glycerine Filled = 30° F to 160° F |

Design meets or exceeds ASME B40.100 pressure gauge standard.



4

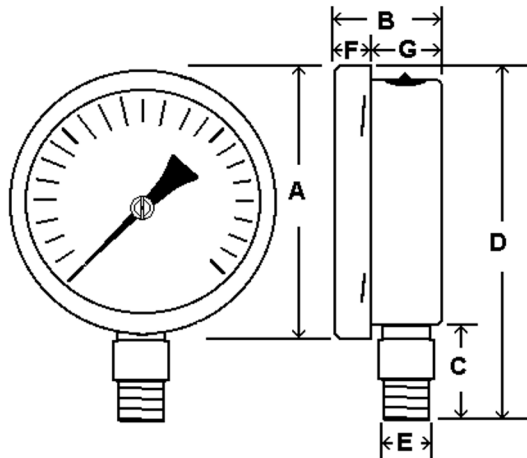

AVAILABLE OPTIONS*

- Certificate of Accuracy, NIST traceable
- Custom Dial
- Liquid Fill Options, see page 176
- Special Connection Size
- Cleaned for Oxygen Service (dry only)
- Polycarbonate Lens

*Lead times/minimums may apply

APPROXIMATE SHIPPING WEIGHTS/ BOX QUANTITIES

| Dial | Unit | A | B | C | D | E | F | G |
|------|------|-------|-------|-------|-------|----------|-------|-------|
| 6" | In. | 6.75" | 2.05" | 1.50" | 8.41" | 1/4" or | 0.73" | 1.27" |
| | mm | 172 | 52 | 38 | 214 | 1/2" NPT | 18 | 32 |

| Dial Size | Est. Unit Wt. | Box Qty |
|-----------|-----------------------|---------|
| 6" | 2.15 lbs (0.98 kg) | 10 |