



# 6002 6" ALL STAINLESS LOWER BACK MOUNT

Heavy duty, all stainless steel gauge with removable bezel, adjustable pointer  
 1% accuracy, welded case-to-stem connection, dry yet fillable

## SPECIFICATIONS

<b>Dial</b>	6" (150 mm)
<b>Case</b>	Stainless steel, dry yet fillable Welded case-to-stem connection
<b>Wetted Parts</b>	316 stainless steel
<b>Movement</b>	With overload/underload stops
<b>Bezel</b>	Removable, stainless steel
<b>Lens</b>	Laminated safety glass
<b>Pointer</b>	Micro adjustable, black aluminum
<b>Connection</b>	Lower back mount 1/4" NPT
<b>Scale</b>	Standard: single scale psi
<b>Accuracy</b>	1% of span ASME B40.1 Grade 1A
<b>Ambient Temp</b>	Dry = -30° F to 180° F Glycerine Filled = 30° F to 160° F

4

*Design meets or exceeds ASME B40.100 pressure gauge standard.*

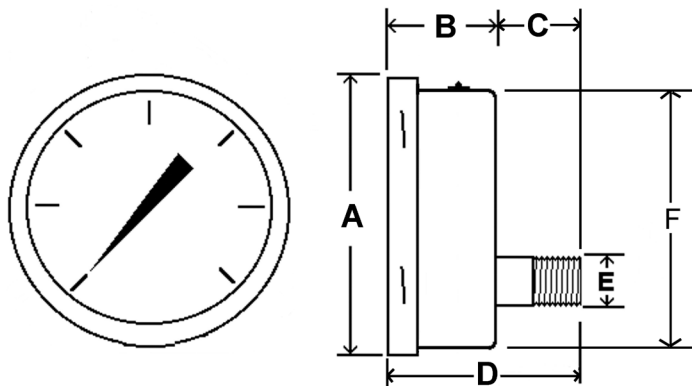

Dial	Unit	A	B	C	D	E	F
6"	In.	6.76"	2.02"	1.35"	3.37"	1/4" or	6.24"
	mm	172	52	34	86	1/2"	158

## AVAILABLE OPTIONS\*

- Certificate of Accuracy, NIST traceable
- Custom Dial
- Liquid Fill Options, see page 176
- Special Connection Size
- Cleaned for Oxygen Service (dry only)
- Polycarbonate Lens
- 1/2" NPT or Custom Connections

\*Lead times/minimums may apply

## APPROXIMATE SHIPPING WEIGHTS/ BOX QUANTITIES

Dial Size	Est. Unit Wt.	Box Qty
6"	2.20 lbs (1.00 kg)	upon request