



# LP2-SS LOW PRESSURE ALL STAINLESS

Capsule type pressure gauge for accurate measurement of low pressures  
Suitable for air, water, oil, gas or any other media not corrosive to stainless steel

## SPECIFICATIONS

<b>Dial</b>	2 ½" (63 mm)
<b>Case</b>	Stainless steel, dry non-fillable
<b>Wetted Parts</b>	316 stainless steel
<b>Bezel</b>	Removable, stainless steel
<b>Lens</b>	Heavy duty glass
<b>Pointer</b>	Adjustable, black aluminum Adjustment screw on dial face
<b>Connection</b>	Center back mount ¼" NPT
<b>Scale</b>	Standard: single scale inches of water column or psi
<b>Accuracy</b>	2-1-2% of span 2 ½" ASME B40.1 Grade A
<b>Ambient Temp</b>	-30° F to 180° F

*Design meets or exceeds ASME B40.100 pressure gauge standard.*



5

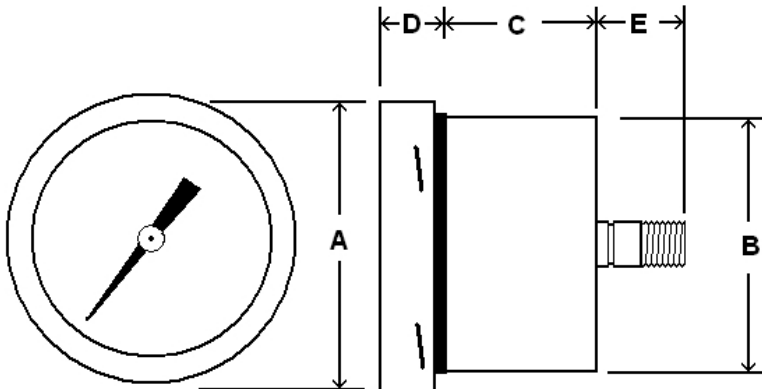

Dial	Unit	A	B	C	D	Conn.	E
2 ½"	In.	2.95"	2.57"	1.23"	0.58"	¼" NPT	1.05"
	mm	75	65	31	15		27

## AVAILABLE OPTIONS\*

- Certificate of Accuracy, NIST Traceable
- Custom Dial
- Special Connection Size
- Other Lens Material
- Cleaned for Oxygen Service
- Protective Rubber Cover, see page 121
- Dual Scale

\*Lead times/minimums may apply

## APPROXIMATE SHIPPING WEIGHTS/ BOX QUANTITIES

Dial Size	Est. Unit Wt.	Box Qty
2 ½"	0.60 lbs (0.28 kg)	upon request