



# SEC-201L LIQUID FILLED LOWER MOUNT

Glycerine filled for added durability in applications where vibration or pulsation is present  
Stainless steel case and bezel, copper alloy internals

## SPECIFICATIONS

2	<b>Dial</b>	2 1/2" (63 mm)
	<b>Case</b>	Stainless steel, glycerine filled
	<b>Wetted Parts</b>	Copper alloy
	<b>Bezel</b>	Stainless steel, fixed
	<b>Lens</b>	Polycarbonate
	<b>Pointer</b>	Black aluminum
	<b>Connection</b>	Lower mount
		2 1/2" dial = 1/4" NPT
	<b>Scale</b>	Standard: psi/BAR (x 100 = kPa)
	<b>Accuracy</b>	3-2-3% of span ASME B40.1 Grade B
	<b>Ambient Temp</b>	Glycerine Filled = 30° F to 160° F
		Dry = -30° F to 180° F

*Design meets or exceeds ASME B40.100 pressure gauge standard.*

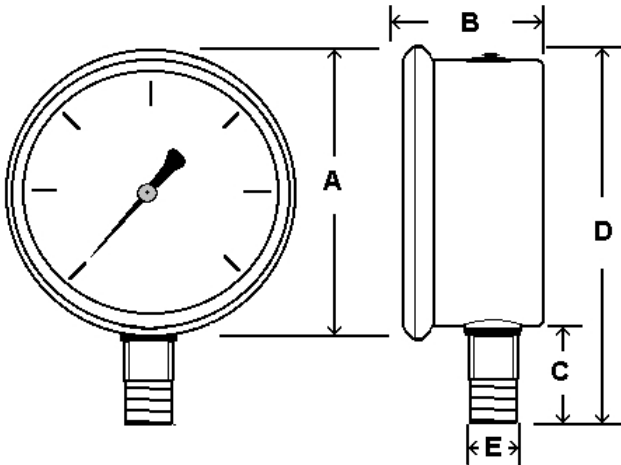

Dial	Unit	A	B	C	D	E
2 1/2"	In.	2.65"	1.20"	0.88"	3.30"	1/4"
	mm	68	30	22	84	NPT

## AVAILABLE OPTIONS\*

- Certificate of Accuracy, NIST traceable
- Custom Dial
- Liquid Fill Options, see page 176
- Anti-Vibration Movement, see page 109
- Dry, Fillable Case
- Special Connection Size
- Protective Rubber Cover, see page 121
- Max/Min Pointer, see page 122

\*Lead times/minimums may apply

## APPROXIMATE SHIPPING WEIGHTS/ BOX QUANTITIES

Dial Size	Est. Unit Weight	Box Qty
2 1/2"	0.45 lbs (0.20 kg)	100