

Threaded full size diaphragm seal Heavy duty, bolted construction

SPECIFICATIONS

Design	Standard: Diaphragm welded to upper housing Also available: Clamped
Instruments	Gauges, pressure switches, transmitters
Appropriate Dial Size	2 1/2" (63 mm) through 6" (152.4 mm)
Pressures	Vacuum or pressures up to 2500 psi
Upper Housing	Chrome plated carbon steel or stainless steel
Wetted Materials (Diaphragm/ Lower Housing)	Standard: Carbon, 304 or 316 stainless steel Also available: Hastelloy® C276, Monel®, Tantalum, PTFE (clamped), Carpenter 20®, Titanium, Others upon request
Process Connection	1/4" FNPT, 1/2" FNPT, 3/4" FNPT, 1" FNPT
Instrument Connection	1/4" FNPT, 1/2" FNPT
Bolts	Galvanized steel (CS upper) Stainless steel (SS upper)
Gaskets	Standard: Buna N® Also available: Viton®, PTFE, Grafoil®, others upon request
Process Temperature¹	-4°F to 212°F (-20°C to 100°C)



AVAILABLE OPTIONS*

- Clamped diaphragm
- Flushing (1/4") connection available on lower housing
- Male threaded process connection
- Oxygen cleaned
- Material analysis certificate
- High temperature with grafoil gasket
- Clean-out ring (available on clamped designs only)

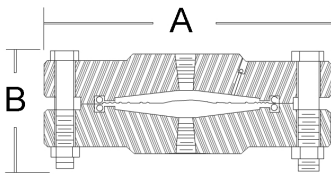

STANDARD

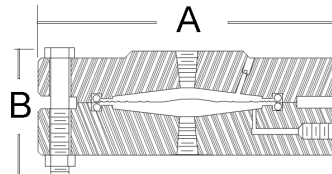

WITH FLUSHING CONNECTION

*Lead times/minimums may apply

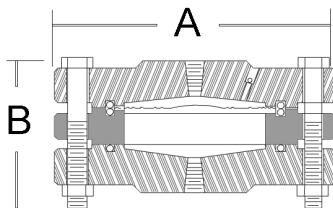

WITH CLEAN-OUT RING

Diaphragm Seal	Unit	A	B
Standard	In.	4.00"	1.50"
	mm	100	38
With Flushing Connection	In.	4.00"	1.75"
	mm	100	45
With Clean-out Ring	In.	4.00"	2.13"
	mm	100	54

Notes:

1. Process Temperature Rating can vary based on materials of construction, system fill fluid, gaskets and pressure gauge selection.